

NOSKE-KAESER Integrated Unit (40') for Reefer Container Refrigeration

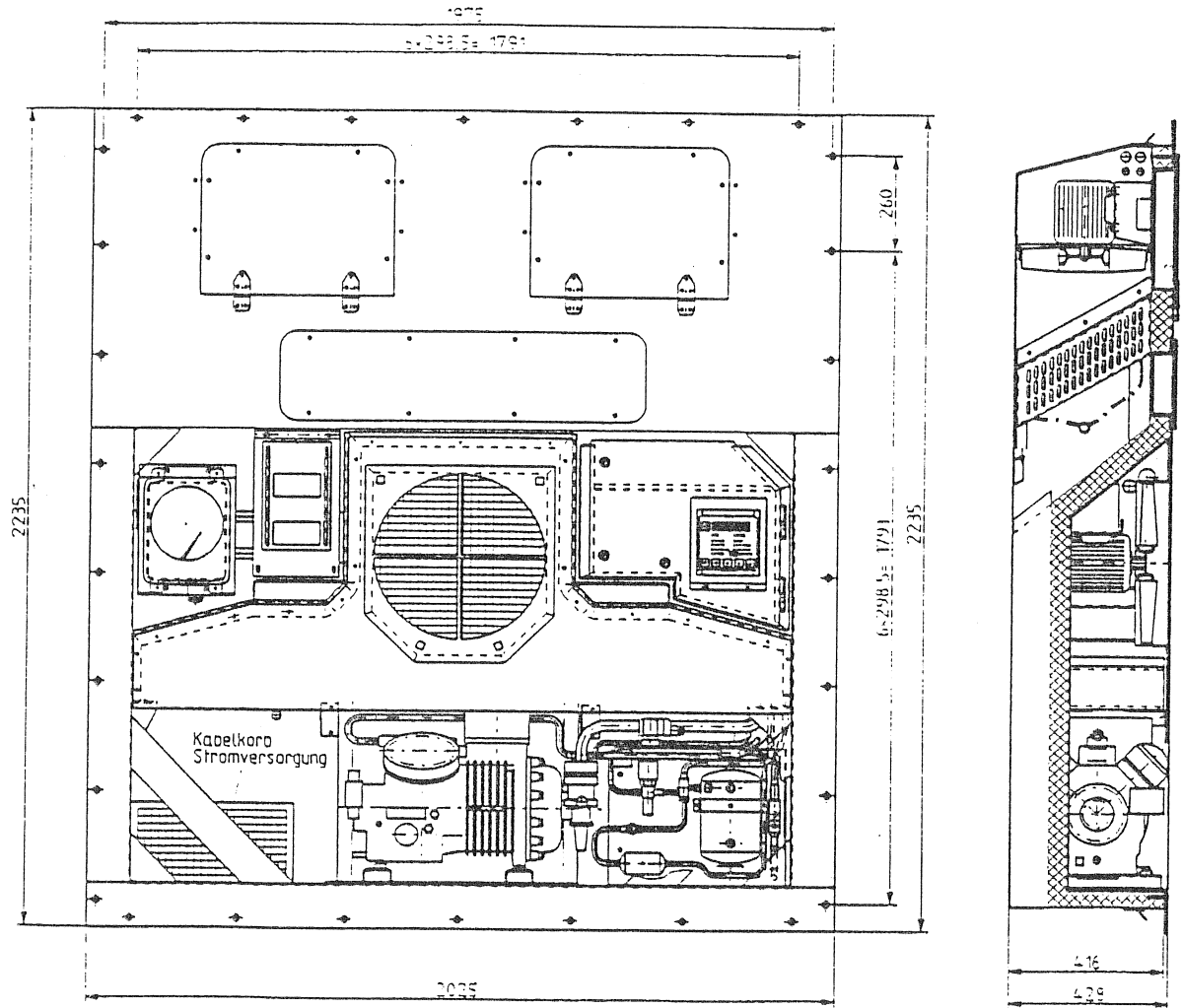

Technical Data

The equipment can be utilized for heating and refrigeration at all outdoor temperatures between -30°C and +55°C without restrictions. The indoor temperature can, depending on the outdoor temperature, lie between -25°C and +20°C.

Temperature	Refrigeration Capacity	Power Consumption (unit)
Return temperature -25°C	2.200 ... 3.150 Watt	4.200 Watt
Return temperature -17,8°C	4.200 ... 5.200 Watt	5.500 Watt
Supply temperature ± 0°C	10.500 Watt*	8.600 Watt*

* (best adjustment to the capacity need with switching out cylinders and a hot gas bypass system)

At 60 Hz, 38°C ambient temperature

- Heater output : 4,4 kW (60 Hz)
- Refrigerant : R 134a
- Air supply, evaporator
 - 1. Frozen mode : 3.000 m³/h, low speed (3,2 mm WS ext. pressure)
 - 2. Chilled mode : 5.700 m³/h, high speed (12,5 mm WS ext. pressure)
- Power supply : 360/460 V, 50 Hz
400/506 V, 60 Hz
- Fresh air cycle : 180 m³/h, continuously adjustable